

ABOUT YOUR MAG245 MICRO / MAG250 MICRO

About your MAG245 Micro / MAG250 Micro

Thank you for purchasing our product MAG245/MAG250, which makes it possible to access to TV and movies through your digital television service.

You can control all functions of MAG245/MAG250 by using remote control for navigating on screen menu provided by your service provider.

Getting Started

Thank you for purchasing our product MAG245/MAG250, which makes it possible to access to TV and movies through your digital television service.

You can control all functions of MAG245/MAG250 by using remote control for navigating on screen menu provided by your service provider.

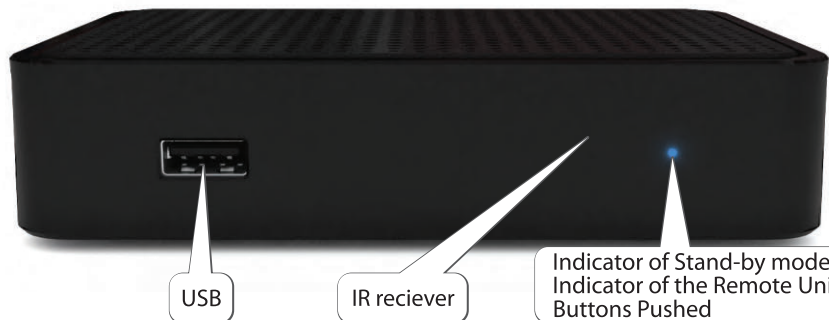

USB

IR receiver

Indicator of Stand-by mode/
Indicator of the Remote Unit
Buttons Pushed

BACK PANEL MAG245 / MAG250

Connecting on the Back Panel

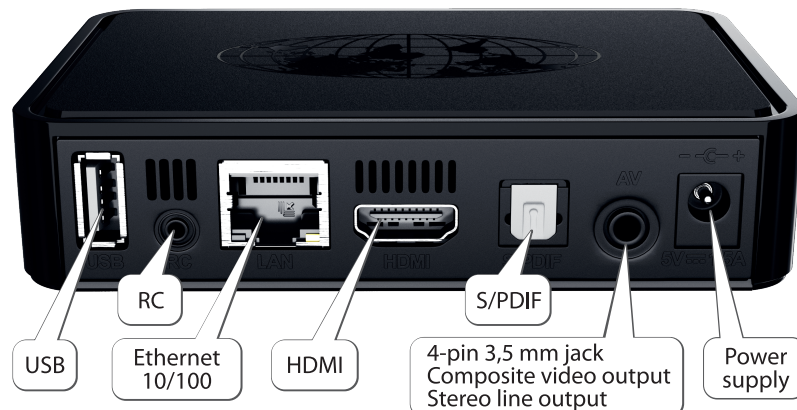

Digital TV Connecting to the Network

MAG245 Micro / MAG250 Micro receives TV channels and movies from the "digital TV" network. Your services provider had been already installed the connection with the mentioned network.

- Connect cable for "digital TV" network into "digital TV"/Ethernet port on your product.

UNPACKING AND INSTALLATION THE PRODUCT

After the product extraction out of the package it is necessary to handle it with care, do not drop, shake it and afford other influence.

The product is designed for horizontal allocation onto flat surface.

Do not place the product onto slippery surface, in place where it may be exposed to vibration or hazard to drop and other possible risks to the product to be damaged which may cause invalidation the product guarantee.

Do not dispose the product onto soft surface like on the carpet, bed, etc., for such surfaces cease access to the ventilation openings and complicate air flow that may cause to the product overheating and to invalidate guarantee in result.

Do not locate the product into the furniture in case of vacant clearance around the product is not provided for the sufficient product ventilation.

Do not place the product in place where it may be exposed to influence of direct sunlight, next to the sources of open fire and converters.

Do not dispose the product on surfaces which in operating process may get warm, for instance,

video record player or intensifier and do not put anything on the top of the shell as well.

Do not cover the product with anything. Containing liquids objects, such as vase, plant pot are not to be placed next to or on the product.

Do not touch or move the product during its operation. Switch off the product if you need to shift it.

The product is intended for use indoors. The power supply cord is to be put to prevent its deformation and jamming and touching it

with other objects as well. The power supply cord is not to be laid under the carpets or blocked with anything where any damage may not be noticed.

Power supply unit
The product should be used with power supply unit provided by the manufacturer only.

The power supply unit is fitted out with plug which is intended for connecting to socket in your country usage. In case of the necessity in the product connecting in other country or in the region with other data of electric circuit the power supply unit adopted for use in the specified area should be received from the manufacturer.

Operation
The outer power supply unit of the product is getting warm in operation. In case of outer power supply unit gets hot, switch off promptly and get in touch with the equipment supplier for its replacement.

Protection from atmospheric electricity or not using for a long time.
On coming the thunderstorm and also in case of the product is intended to be in no use for a long time, disconnect the power supply cord out of socket, switch off Ethernet, video and audio cables.

It is to protect the product from thunder discharges and power surges in the circuit.

Usage with Plasma Displays
In the product usage for watching with plasma screens do not pause the picture more than 5 minutes, otherwise it may cause 'burn-out' pixels on the screen. It is not considered as a defect of the product but peculiarity of plasma screens structure. The producer does not bear the responsibility for damages had been caused in such manner.

The Arrangement Designation

The product is designed to receive and record TV pictures and sound signals. Any other use is prohibited.

It means Telecommunication Technologies insists on the product usage in entirely accordant to the law of copyright. The compliance with the specified laws leaves on conscience of the user. The unauthorized copying of the protected materials or spreading of the specified copies under definite conditions may violate the law of copyright and is to be previously adopted by possessor of the rights for the further commercial use.

Updating Software
The product possesses the capability of automatic software updating.

The manufacturer and your services provider reserve the right for automatic software updating to improve the product functional capability.

During the software updating the product should not be used for watching and switched off until the complete software updating.

During the software updating the product switching off is inadmissible. The updating takes several minutes and since then you are able to continue enjoy on all delights of digital television services.

The product and accessories are packed into recycled package and plastic bags. Please keep all the packing materials for the further transportation. MAG245 / MAG250 is delivered with the following accessories:

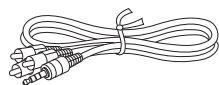

Audio/Video cable
3,5 mm Jack to 3 RCA



Instruction manual



IR remote control



Outer power supply unit, 5V



Batteries for IR Remote
AAA-size 2pcs.

In case of absence of any of the specified accessories please refer to your services provider.

CONNECTING TO MAG245 / MAG250

The typical product connecting to TV and audio intensifier is shown on the presented diagram:

CONNECTING TO TV-SET WITH HDMI CONNECTOR - BEST QUALITY



Connector:	HDMI
Cable:	HDMI
Video:	SD + HD
Audio:	digital

CONNECTING TO TV-SET (AUDIO/VIDEO INPUT) - GOOD QUALITY



Connector:	CVBS, L, R
Cable:	3,5 mm Jack to 3 RCA
Video:	only SD
Audio:	analog

Composite video signal.
For video/audio connection

Warning! Switch off all arrangements (TV, intensifier, etc.) and take power supply out of socket before connecting and any cables disconnecting. In case of the intensifier does not connected leave digital audio outlets of your product not connected.

Video Connecting

The product allows connecting the following video cables:

- HDMI – provides the best quality of picture and allows playing of digital video of high definition (HD).
- Composite (CVBS) - enables standard picture quality. Use the connection with the best quality which could be applied with your equipment.
- In case of your TV has HDMI inlet, use HDMI cable for the product connecting to TV through HDMI outlets.
- In case of your TV is capable to operate with connection through component video inlet, use component video cable for the product connecting to TV through component video outlets.

Attention! In all cases follow coloration of connectors and sockets on your equipment.

Audio Connecting

The product allows to conduct the following connections:

- Left and right channels for playing stereo sound through (L and R outlets).

Attention! After the product unpacking please wait up until the arrangement warms up to indoor temperature to avoid condensation which may cause short circuit.

USING REMOTE CONTROL TO CONTROL THE DEVICE

This section explains how to unpack Remote Control (RC) and prepare it for work. Your service provider can supply the product with an alternative RC. In that case please refer to the manual supplied by your service provider.

Inserting batteries

Remote Control requires two batteries type AAA, R03, LR03, UM-4, 286.

Inserting batteries into Remote Control.

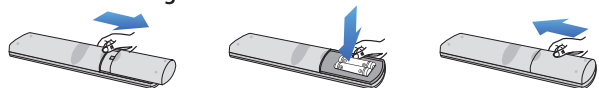

Shift the battery cover located on back side of RC as shown in the picture.

Insert two batteries type AAA (included in package) taking care to observe the correct polarity as shown on RC.

Replace the battery cover as shown in the picture. Average lifetime of a batteries is about 1 year.

Important information about using batteries

Do not mix different types of battery or old and new batteries.

Do not use rechargeable batteries with the remote control.

Remove the batteries from the remote control if you are not going to use it for several weeks, to avoid the risk of leakage.

Please respect your environment and any local regulations and dispose of old batteries in a responsible manner.

Caution! Do not attempt to recharge the batteries. Immediately remove any leaking batteries. Take care when handling leaking batteries as they may cause burns to the skin or eyes, or other physical injuries.

Introduction into the Programmable Remote Control Unit

MAG245 Micro / MAG250 Micro package includes a remote control with a special block of five programmable buttons (marked with blue print colour), which you may want to choose for controlling other devices (TV set, amplifier).

To program the buttons do the following:

Press the «On/Off» and «A/V» buttons at the same time and hold it for 2 seconds. When the green light of the «On/Off» button will stop blinking and will light steadily, it means the RC is ready to learn.

- Press the button you want to «teach» — the green light will start blinking.
- Place the infrared lamps of two RCs opposite each other and press the button on the RC of the other device, the function of which you wish to copy on device RC. Hold for 2 seconds.
- After the green light two quick blinks you may continue programming other buttons.
- Repeat the procedure described above for all buttons you want to program for controlling external devices.
- Press the the «On/Off» and «A/V» buttons to save the programmed data; the green light should fade off.

Reset

Press SETUP and OK buttons at same time, and hold for 2 seconds red LED will flash 5 times. Reset is done.

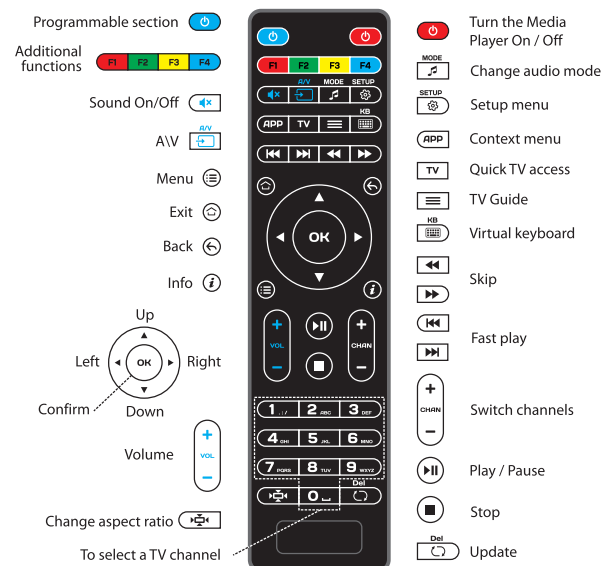

Programmable section

Additional functions

Sound On/Off

AV

Menu

Exit

Back

Info

Up

Down

Volume

Change aspect ratio

To select a TV channel

Turn the Media Player On / Off

Change audio mode

Setup menu

Context menu

Quick TV access

TV Guide

Virtual keyboard

Skip

Fast play

Switch channels

Play / Pause

Stop

Update